



**DIRECT**



**MOVES**



## **Littlemoor Road**

, Weymouth DT3 6LA

- Two bedroom first floor apartment
- Short stroll to Weymouth Beach & coastal walks
  - Nearby transport links
- Recently modernised throughout
  - Own private entrance
  - Close proximity to local amenities

**£130,000 Leasehold**







### Entrance/ Inner hallway

Accessed via an obscured double-glazed UPVC entrance door, the hall features stairs leading up to the first-floor accommodation. Upstairs there is a storage cupboard housing the meters, a hatch providing access into loft space, ceiling lighting, and doors to all rooms.

### Kitchen

8'6" x 5'10"

A modern rear aspect kitchen fitted with a range of eye and base-level units, incorporating a stainless-steel sink with mixer tap, and an electric oven with hob and extractor hood above. The space also benefits from a double-glazed window and ceiling spotlights, providing a bright and practical cooking area.

### Lounge

12'9" x 10'9"

A light and welcoming front aspect room with a double-glazed window, picture rails, and ceiling lighting — offering a comfortable space for both relaxation and dining.

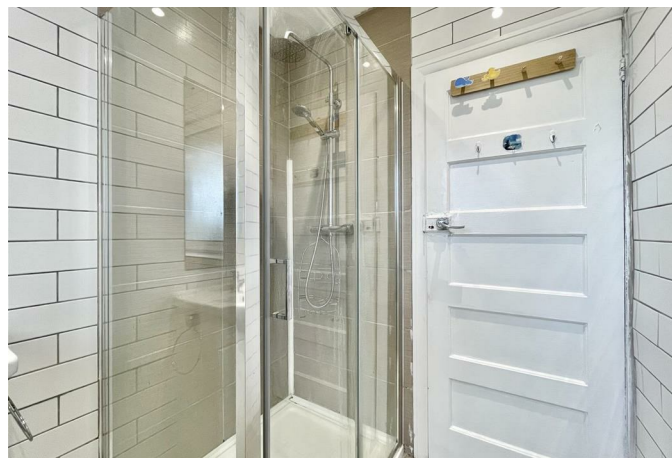

### Bedroom 1

12'9" x 9'6"

A generous front aspect double bedroom with a double-glazed window, picture rails, ceiling lighting, and space for freestanding wardrobes and furniture.

### Bedroom 2

8'10" x 5'10"

A cosy rear aspect bedroom with a double-glazed window, ceiling lighting, and power points — ideal as a guest room, nursery, or study.

### Shower room

5'10" x 5'6"

A fully tiled, contemporary bathroom with an obscured double-glazed window, corner shower enclosure featuring both handheld and rainfall showerheads, low-level WC, hand wash basin with stainless mixer tap, and recessed ceiling spotlights.

### Disclaimer

Direct Moves Estate Agents make no representations or warranties regarding the accuracy, completeness, or reliability of the property details provided. These details are for informational purposes only and should not be relied upon in any way. The information is not intended to form part of any contract and does not constitute an offer or guarantee by Direct Moves.





Local Authority **Weymouth & Portland Borough Council**  
Council Tax Band **A**  
EPC Rating **E**

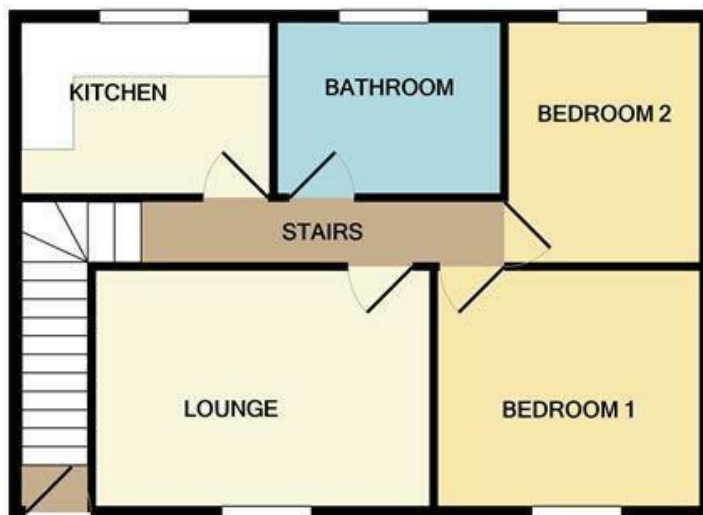

LITTLEMOOR ROAD  
TOTAL APPROX. FLOOR AREA 496 SQ.FT. (46.1 SQ.M.)

Whilst every attempt has been made to ensure the accuracy of the floor plan contained here, measurements of doors, windows, rooms and any other items are approximate and no responsibility is taken for any error, omission, or mis-statement. This plan is for illustrative purposes only and should be used as such by any prospective purchaser. The services, systems and appliances shown have not been tested and no guarantee as to their operability or efficiency can be given.  
Made with Metropix ©2020

#### Direct Moves Estate Agents Office

9 Westham Road  
Dorset  
Weymouth  
DT4 8NP

#### Contact

01305 778500  
[sales@directmoves.com](mailto:sales@directmoves.com)  
<https://directmoves.com/>

Agents Note: Whilst every care has been taken to prepare these particulars, they are for guidance purposes only. All measurements are approximate and for general guidance purposes only and whilst every care has been taken to ensure accuracy, they should not be relied upon and potential buyers/tenants are advised to recheck the measurements.

